

Montageanleitung Mounting instructions

H-Gestell / H-frame

007.00168_V03/2017



Competence in Trailers

de / en

• Alle Abbildungen sind Musterabbildungen / All illustrations are representative.

210.12163 (H xx2111)

210.12164 (H xx2513)

► Inhalt prüfen / Check content:

1. H-Gestell Teil1 geschweißt / H-frame part 1, welded
2. 6kt.-Schraube / Hexagonal head screw, M6x20
3. Federscheibe / Lock washer, A8
4. Scheibe / Washer, A6,4
5. U-Profil Teil 2 / U-profile part 2

Einsatz bei / can be used for: **STARTRAILER 2017'**

Gebote / Bid:



Gefahren / Dangers:



x1
x6
x6
x6
x2

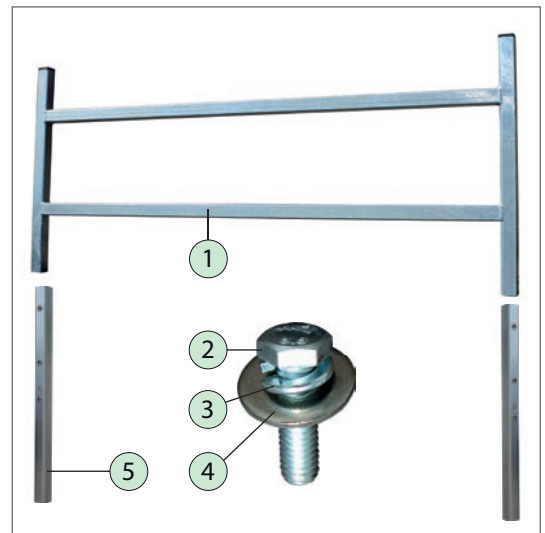

Montage - Schwierigkeitsgrad:
mounting - degree of difficulty:

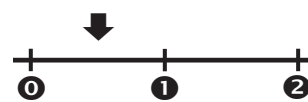

0 ganz leicht / easy
1 mittelschwer / moderate
2 schwer / difficult

Sie brauchen / you need:

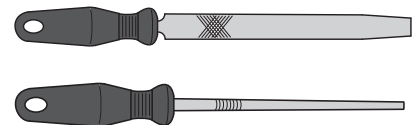
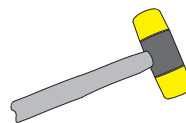
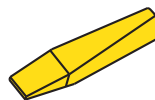

Anwendungsbeispiel /
Example of application:



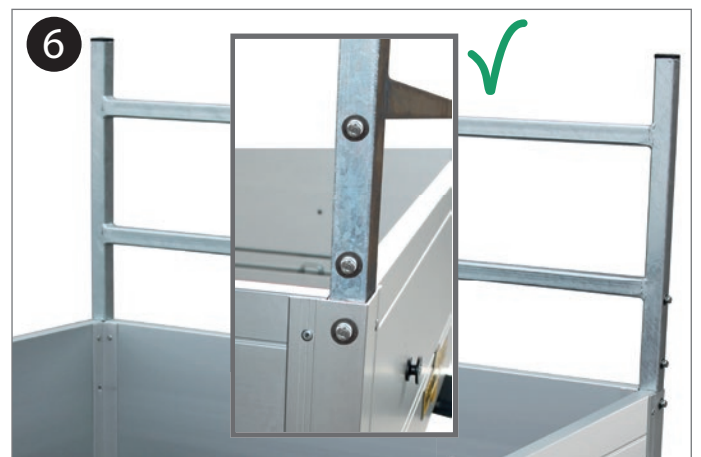
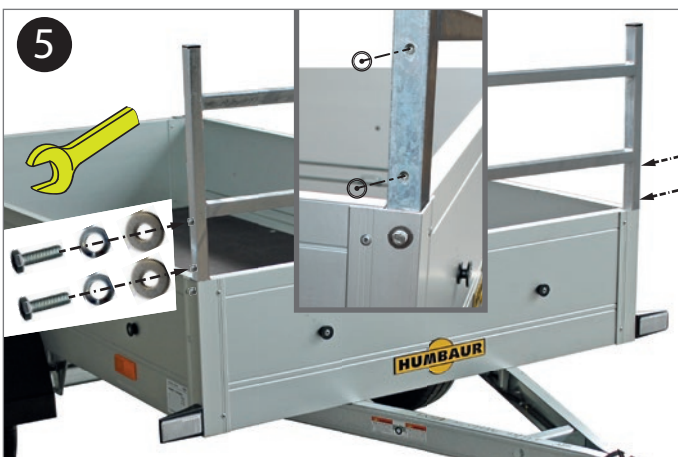
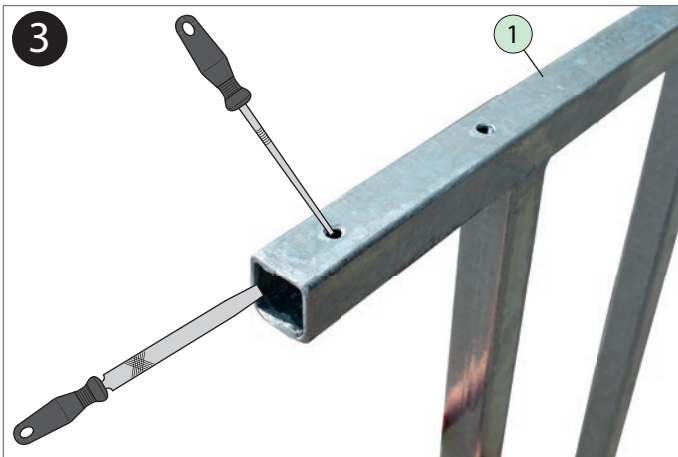
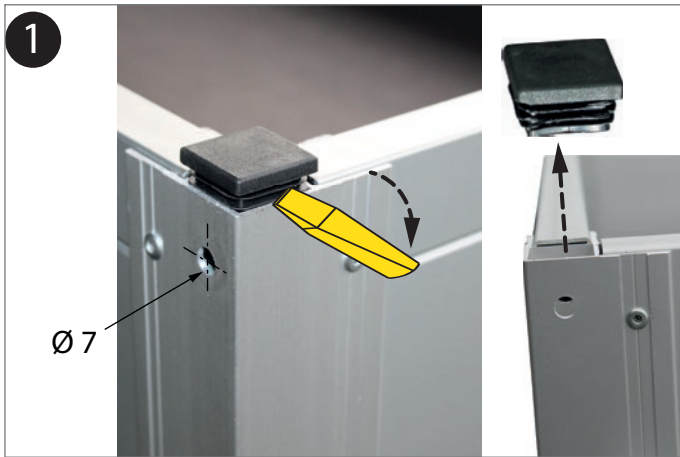

Bedienung / Wartung des H-Gestells- siehe Betriebsanleitung PkW-Programm Teil 1 - Allgemein.
Operation / maintenance of the H-frame - see operating instructions including car program Part 1 - General.



Für die fachgerechte Montage ist der Kunde verantwortlich. Für eventuelle Sach- oder Personenschäden die durch unsachgemäße Montage entstehen, übernimmt die Fa. Humbaur GmbH keine Haftung. *The customer is responsible for proper mounting. The company Humbaur GmbH assumes no liability in case of any property damage or personal injury caused by improper mounting.*